

# aquaflush®

simply better, in every way



## stoma stopper instructions for use

# stoma stopper

## directions for use

Aquaflush stoma stoppers are small silicone stoppers (made from medical grade silicone that can be used for up to 28 days in the body) that are used to seal stoma sites at various parts of the body.

### What exactly are Aquaflush stoma stoppers?

Soft, low profile and comfortable and are unique in being of an adjustable in length and come in a variety of shaft diameters depending on the size of the stoma. They all have a chamfered circular 15mm skin disc with small tab to make it easier to remove. They prevent Stomal Stenosis\*\* (closing of the stoma in-between catheterisations) and leakage from the stoma by forming a seal in between insertions of the catheter.

### Why use an Aquaflush stoma stopper?

Stoma stoppers are indicated for patients in antegrade continence enemas (ACE) where they are required to seal the tract or maintain an open or unobstructed Ace Stoma in between insertions of the enema catheter (usually every 24 to 48 hours). People that have undergone the Mitrofanoff procedure are also suitable to use an stoma Stopper (stomas formed for catheter introduction into the bladder). Aquaflush Stoppers can also be used for any other stoma of similar size elsewhere in the body.

### How do I adjust the length of an Aquaflush Stopper

You will see from the below diagram the stopper has a number of preformed severance points (where you can shorten the length of the stopper ideally with sterile scissors – ask your prescribing professional for details). This allows you to reliably shorten the stoppers length to suit your own needs. Your prescribing Healthcare Professional will advise you on your own specific stopper length and how best to perform this procedure.

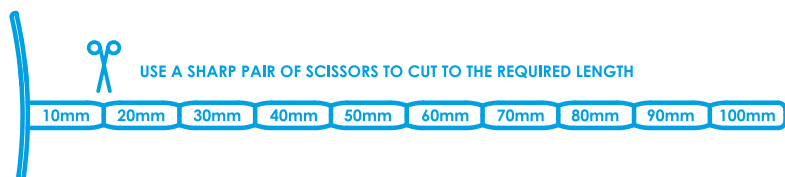

### Where do I put the Aquaflush stoma Stopper?

Your ACE stoma site should be cleaned and dried before attempting to insert the stopper. First adjust the Aquaflush Stoma Stopper to the required length (if necessary as per previous instructions) and lubricate the Stoma Stopper with a water based lubricant for easier insertion. The stopper is then inserted gently into the tract in the same way as when performing ACE

**Useful Tip:** Make a note of the date you first used a stopper to ensure you do not use it for more than 30 days.

### How do I keep the Aquaflush Stopper in place?

You can use the Aquaflush Stoma Stopper dressing (AFD1) once the stopper is fully inserted to secure the stopper for up to 24hrs. The stopper can be used for up to 30 days but the dressings are only used once then discarded in accordance to your prescribing professionals advice.

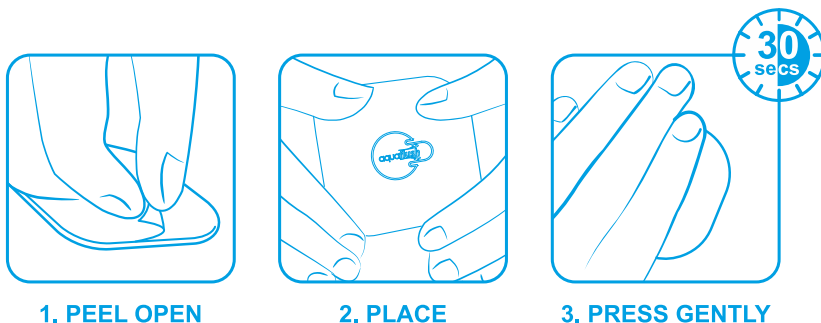

### How do I remove the Aquaflush Stoma Stopper?

You need to remove the Stopper dressing and then the Stopper itself when it is time to perform an ACE washout procedure. To remove lift the small silicone tab on the top of the Stopper to help you to grip the Stopper firmly and gently remove. Clean the stopper as advised by your prescribing healthcare professional. Normally it is cleaned with soap and water then rinsed under the tap and stored in a clean dry place until the ACE catheterisation is complete.

### Routine Maintenance of the Aquaflush Stoma Stopper

Stoma stoppers are relatively short term medical devices which should not be used for more than a maximum of 30 days. Stoppers are reusable only by the patient they are prescribed for. They should be cleaned with soap and water after each insertion and allowed to dry before storage in a clean dry place. If there is any sign of damage to the stopper particularly on the join between stoppers chamfered disc and the stopper shaft do not use the stopper simply replace it with a new one.

**Useful Tip:** It is advisable to keep a spare unopened Stopper for such unforeseen events.

FAQ

**Q:** The ACE stoma closes up in between each washout?

**A:** This can be a serious problem and we suggest you contact the hospital if this happens. They may recommend the use of a stoma stopper in between washouts. This decision **MUST** be made by a qualified specialist healthcare professional that knows about management of ACE.

**\*\*** Stomal stenosis is the commonest complication of the antegrade colonic enema (ACE) procedure, reportedly occurring in 25-55% of patients. As such, a simple stoma stopper device (a small silicone plug sited in the ACE conduit between catheterisations) was designed to prevent stenosis. <J *Pediatr Surg.* 2007 Mar;42(3):522-4. *Early experience with the antegrade colonic enema stopper to reduce stomal stenosis.*>

Warnings

The life of these devices is 30 days intermittent use. The grade of silicone materials is only licensed for this duration. Stoma stoppers should not be used on any patient with a history of allergy to silicone. If there is any irritation to the skin a small amount of petroleum jelly or a keyhole dressing can be used as a temporary barrier. If the irritation persists then the stoma nurse must be consulted.

	Size	Order Code	PIP Code
Stoma Stopper Monthly Pack	8fr	ACEM8	401-8941
Stoma Stopper Monthly Pack	10fr	ACEM10	401-8958
Stoma Stopper Monthly Pack	12fr	ACEM12	401-8966
Stoma Stopper Monthly Pack	14fr	ACEM14	401-8974
Ultra-thin Hydrocolloid Dressings x 30	5x5cm	AFD30	401-8925
Stoma Stopper 100mm [adjustable] + Dressing	8fr	ACE8/100	401-8891
Stoma Stopper 100mm [adjustable] + Dressing	10fr	ACE10/100	401-8909
Stoma Stopper 100mm [adjustable] + Dressing	12fr	ACE12/100	401-8917
Stoma Stopper 100mm [adjustable] + Dressing	14fr	ACE14/100	401-8933

Store in a cool dry place and use stopper for no more than 30 days



VitalCare Nanjing Co., Limited, No.86-8 Shuanggao Road,  
Gaochun Economic Development Zone, Nanjing, 211316 P.R.C

EC REP

VitalCare Ltd.  
6-9 Trinity Street  
Dublin 2  
Ireland  
www.vitalcare.co.uk



0197

Manufactured for -  
Aquaflush Medical Limited  
The Studio, 2 Music House Lane  
Norwich, Norfolk NR1 1QL, UK  
ace@aquaflush.co.uk  
www.aquaflush.co.uk  
For a list of worldwide distributors  
please visit our website